



Fitting Instructions

DETACHABLE TOWBAR RN82Q
For RENAULT LAGUNA HATCHBACK
(2001-)

MATERIALS

A	1	Crossbar
D	2	Side arms
E	4	M8x30x1.25mm Set Bolts, Lock Washers, special M8 'Cage Nuts' and Flat Washers (25mm O.D.)
F	4	M12x35x1.75mm Bolts, 2 Nuts, Lock Washers and Flat Washers (25mm O.D.)
G	2	M10x90x1.50mm Bolts, Nuts, Lock Washers and Large Flat Washers (50mm O.D.)
G1	2	Bushes (17mm O.D. - 56mm long)
ZEP2	1	Electrical Plate (ZEP2)
ZQ	1	Detachable Neck (ZQ2031)

FITTING

1. Insert the special Cage Nuts (**E**) into the forward facing holes provided in rear panel and loosely attach Cross Bar (**A**) using fixings (**E**).
2. Remove the plastic bungs from forward mountings (**G**) and carefully insert Bushes (**G1**) from the outside of the chassis rail. Loosely attach Sidearms (**D**) to the forward mounts using fixings (**G**). Ensure the flat washers are positioned on the inner face of the chassis rail.
3. Pivot Sidearms (**D**) and connect to the Crossbar (**A**) using Fixings (**F**).
4. Fix the detachable neck (**ZQ**) and Electrical Plate (**ZEP2**) as per the additionally provided fitting instruction.
5. Ensure the tow ball is vertical and in it's required position and **fully tighten** all fixings to their recommended torque settings.

Please refer to the vehicle specification for the trailer weight and nose limits, which **must be observed**.

Recommended torque settings: M8 - 27Nm, M10 - 53 Nm, M12 - 95 Nm, M14 - 150 Nm, M16 - 214 Nm

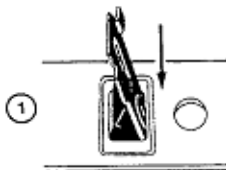
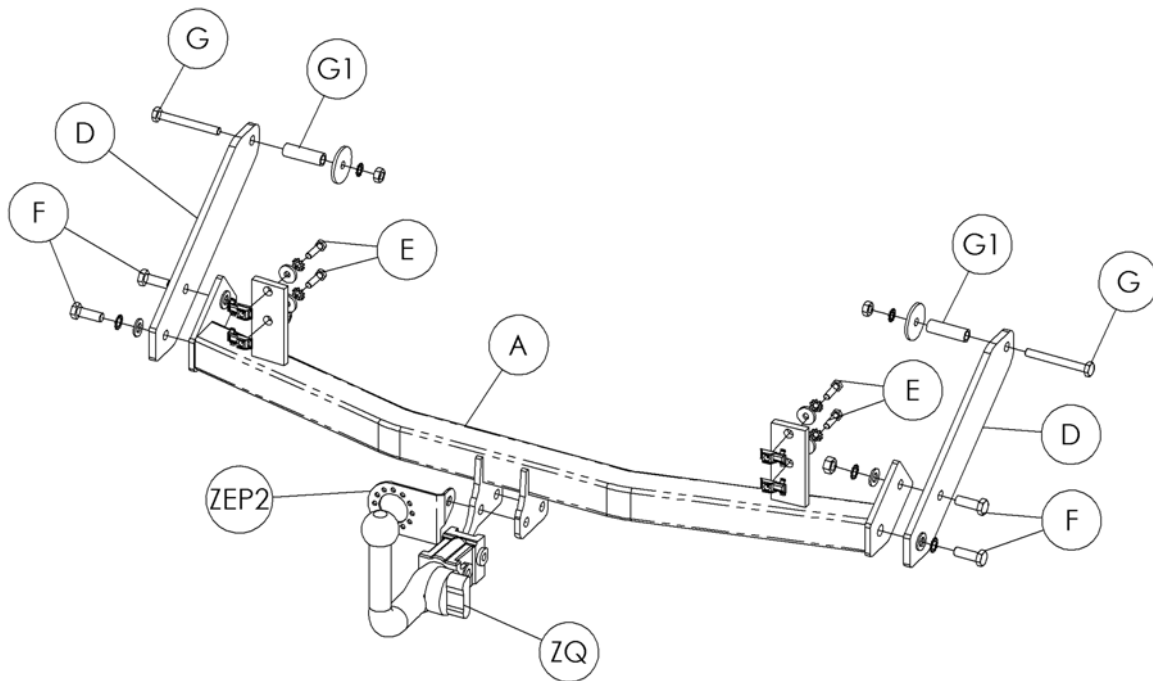

INSERTION

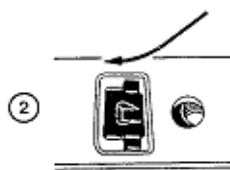

CLIPPED INTO PLACE

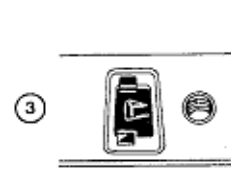

SELF RETAINED



Fitting Instructions

QUANTUM DETACHABLE
TOWBALL SYSTEM
(ZQ XXXX)

MATERIALS

A	1	Receptor/Socket for Towball
T	1	Detachable Towball
K	2	Keys for Detachable Towball
X	4	M12 x 25 x 1.75mm Bolts, Spring Washers and Flat Spacer Washers (25mm O.D)
FC	1	Fixed Weather Cover
RC	1	Removable Weather Cover
L	1	Centreline Label
B	1	Bag
ZQM1	1	Operation Manual

INSTALLATION PROCEDURE

1. Place black plastic fixed weather cap (FC) over forward/ (horizontal system) / upper (vertical system) holes of receptor/socket (A), insert receptor/socket (A) into gap between mounting plates on the towbar, and loosely attach using bolts (X).
 - Notes: (ZEQ1), which is provided as part of the towbar should be refitted on left hand side, together with the electrical socket mounting plate (ZEP1). Only use the 25mm O.D Flat Spacer Washers (X) where there are no loose components attached, i.e. ZEQ1 (electrical socket mounting plate bracket, shown in dashed linetype below).
2. Insert detachable towball unit (T), using procedure detailed in Operation Manual provided, and ensure correct vertical alignment of the towball before fully tightening bolts (X).
3. Attach centreline label (L) to lower edge of bumper.
4. Remove keys (K) from neck of towball, and record the key number in the Operation Manual, together with the fitters name, telephone number, date fitted, vehicle model and registration number and towbar part number.

Bumper Cut – It may be necessary to trim the bumper to allow adequate clearance around the operation handle on the right hand side.

Note: It is essential that the customer/end user is familiar with the operation of the towball system, as detailed in the operation manual, which must be handed to the customer/end user.

Recommended torque settings: M12 - 95 Nm

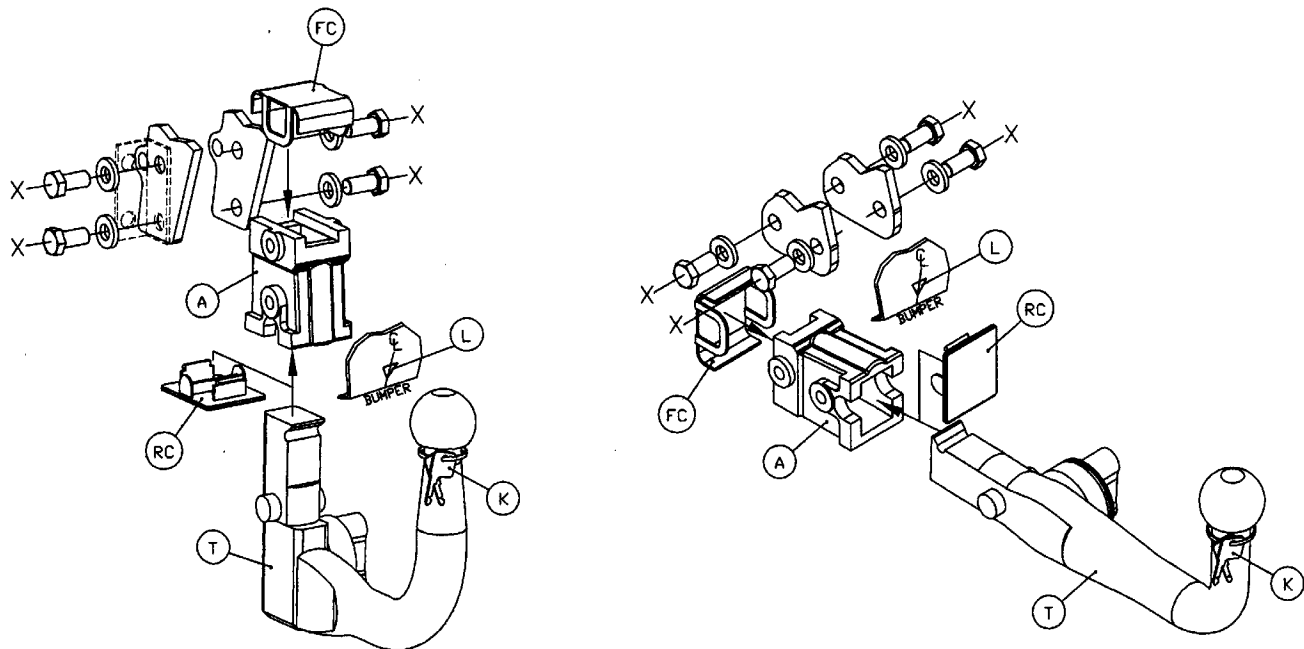

Important – It is essential to ensure that the Operation Manual is in the possession of the end user.

Splaying Centre Profile Shapes

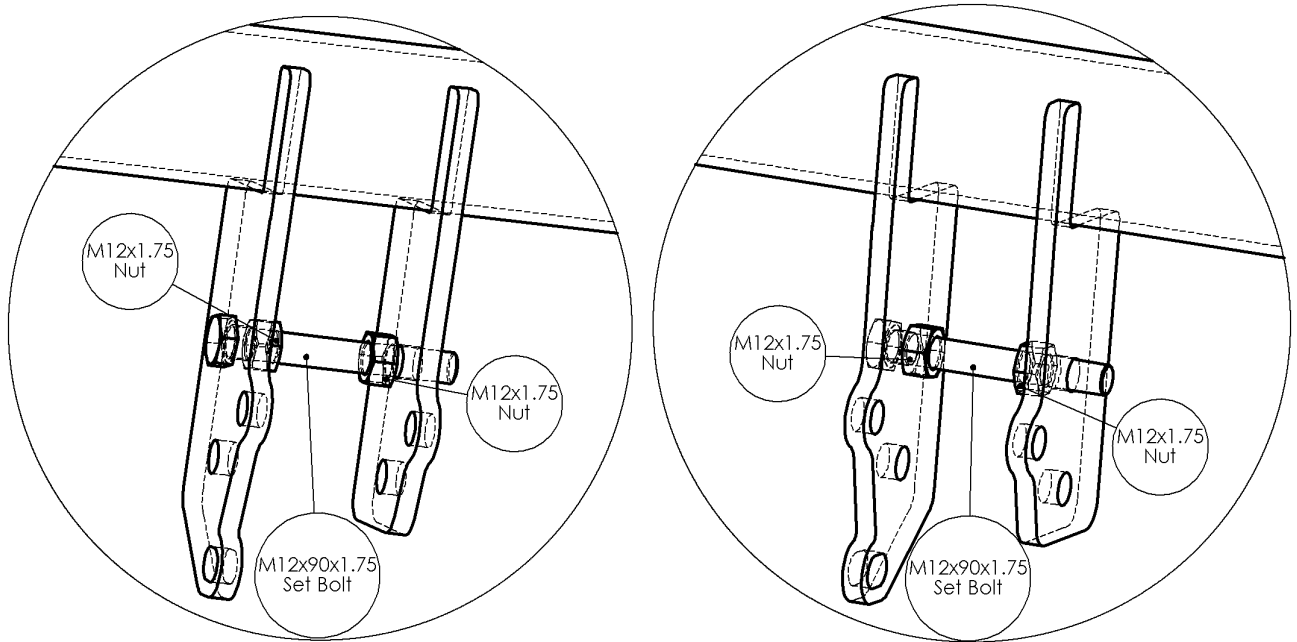

It may be necessary to splay the centre profile shapes further apart in order to fit the centre components of the towbar between them:

- Insert the M12x90x1.75 Set Bolt through one of the profile plates, through the hole nearest the main crossbar.
- Thread both M12x1.75 nuts onto the Set Bolt.
- Screw one of the nuts all the way on, until finger tight.
- Unscrew the other nut so that it splays the two profiles apart far enough to just fit the centre components of the towbar between them when the spreading bolt is removed, (i.e. some allowance will need to be made for “springback” of the steel).