



Fitting Instructions

TOWBAR **VW62U**
For VW Tiguan **For**
2008- **VW62Q**
VW62

MATERIALS

A	1	Cross Bar
B	1	N/S Sidearm
C	1	O/S Sidearm
D	4	M12 x 40 (Grade 10.9) Bolts, Lock Washers and Ø30 Flat Washers
F	6	M12 x 40 (Grade 10.9) Bolts, Nuts, Lock Washers and Ø30 Flat Washers
G	1	M8 x 25 Bolt, Nyloc Nut and Ø35 Neoprene Washer
ZE	1	Electrical Plate (ZEP5)
ZP	1	Electrical Plate Angle Bracket (ZEQ5)

For use with

VW62 fixed neck option ZF3020. *Note: This towbar must be used with either a Witter Towball (part number Z11 or Class A50-1 or A50-X towball dimensionally conforming to A50-1 with a 'D' and 'S' value greater than or equal to that of the towbar.*

VW62Q Detachable neck option ZQ3020. Please refer to ZQ fitting instructions for installation.

FITTING

1. Remove rear light clusters – Torx screws and lock screw (turn anti-clockwise 90° to unlock) and slide rearwards
2. Remove Bumper: Torx screws beneath light clusters and inside wheel arches. Pull back arch liner and unclip arch trim each side. Remove plastic clips at each bumper tip and remove lower bumper retaining screws. Remove number plate top reveal two fixing screws. Disconnect wiring loom and unclip bumper and store carefully.
3. Remove crash beam and refit bolts to prevent water ingress.
4. Ensure threads are clear and insert sidearms (**B**) and (**C**) into chassis rails loosely fixing with Bolts (**D**).
5. Loosely attach crosstube (**A**) to Sidearms (**B**) and (**C**) using fixings (**F**).
6. Fix neck as per instructions on additional sheet using Bolts (**X**), noting the position of Angle Bracket (**ZP**).
7. Tighten all bolts to required torque as detailed below, and refit crash beam mounting bolts to prevent water ingress.
8. If a retractable electrical plate is required, tighten Bolt (**G**) until the plate can be retracted by hand.
9. Cut bumper along panel lines, note that replacement lower bumper panels are available separately from a VW dealer if a removable panel is required
10. Refit bumper, re fitment is the reversal of removal

Please refer to the vehicle specification for the trailer weight and nose limits, which **must be observed**.

Recommended torque settings: **Grade 10.9: M12 – 139Nm**

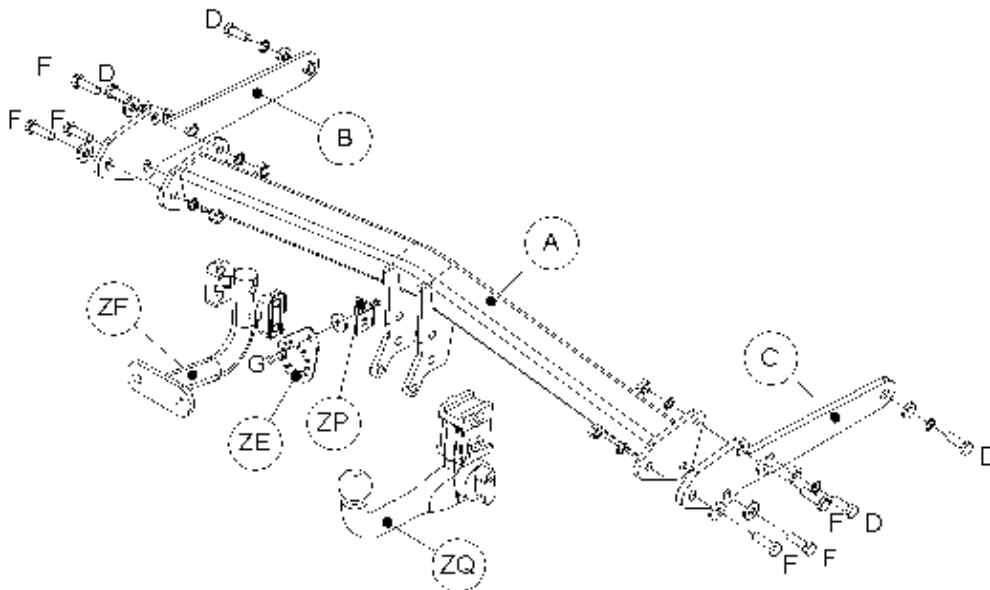

W0001VW62U-FIT\$010806230000